

**CORTE B-B'**  
ESCALA: 1/75

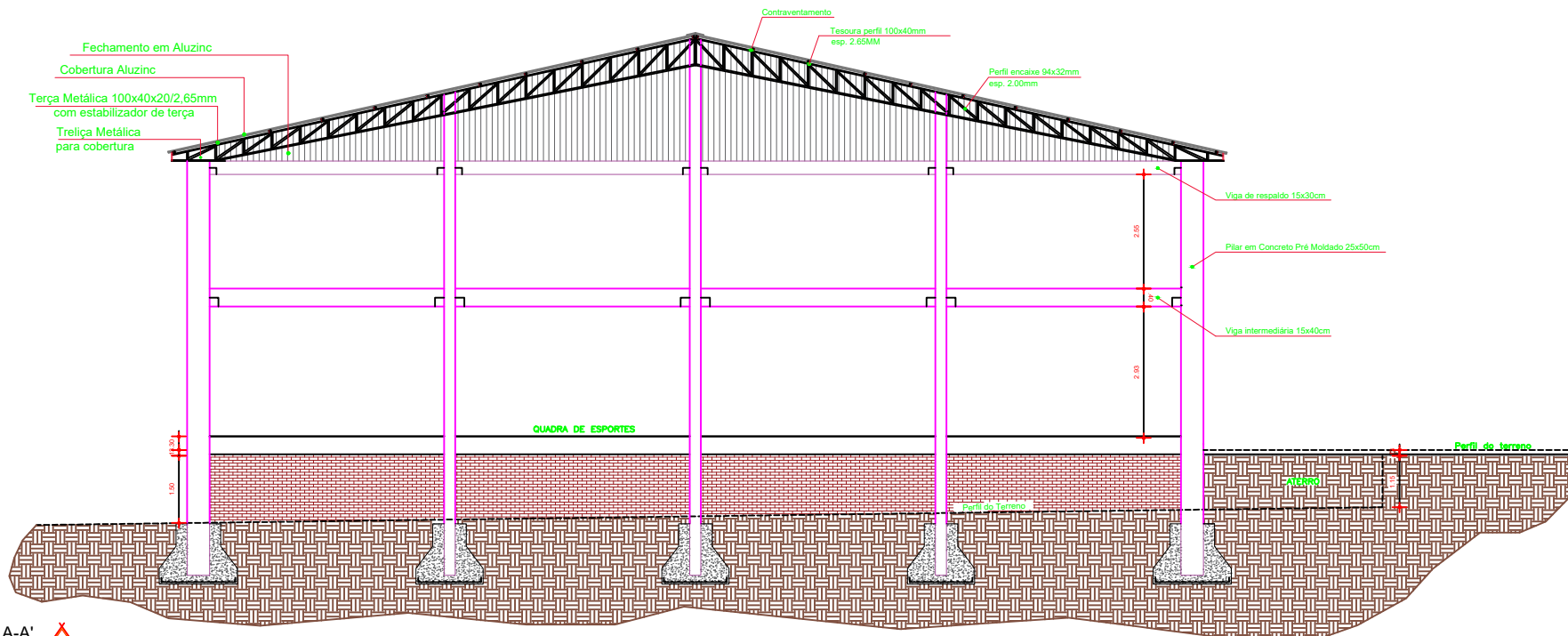

**CORTE A-A'**  
ESCALA: 1/75

**DETALHE ROLDANA**

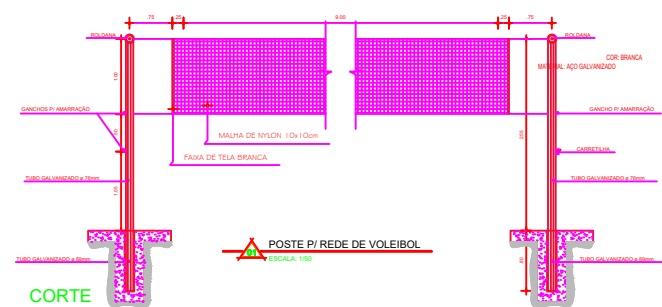
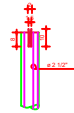

**CORTE**

**MATERIAL: TUBOS E CONEXÕES DE FERRO GALVANIZADO**  
**COR: BRANCA**

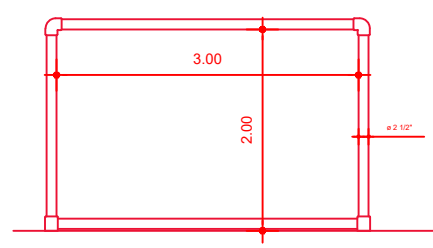

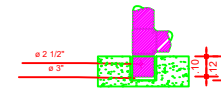

**TRAVE P/ FUTEBOL DE SALÃO**  
ESCALA: 1/50

**DETALHE 01**

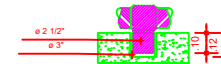

**DETALHE 02**



 <b>PREFEITURA MUNICIPAL DE ALPESTRE</b> <small>PRACA TANCRÉDIO NEVES, Nº 300 CENTRO, ALPESTRE CEP Nº 480-000 TELEFONE: (65) 3788 1188</small>	
<b>INFRAESTRUTURA ESPORTIVA, RECREATIVA E DE LAZER</b> <small>LOCAL: VILA LAJEADO CARNEIRO - ALPESTRE</small>	
<b>CORTES E DETALHES</b>	
<b>PROJETO ARQUITETÔNICO</b>	
<small>PROPRIETARIAL: PREFEITURA MUNICIPAL DE ALPESTRE RUDIMAR ARGENTON CNPJ: 87.612.939/0001-18</small>	<b>VISTO:</b> <hr/>
<small>RESP. TÉCNICO: ELIOUISE RODRIGUES MULLER ENGENHEIRA CIVIL CREA RS213035</small>	<b>VISTO:</b> <hr/>
<small>ÁREA: 770,00m²</small>	<small>ESCALA: 1/75</small>
<small>DATA: MAIO/2018</small>	<small>PRONCHAL: 03/05</small>
<small>FOLHA: A1</small>	