

PLANTA VIGAS DE BALDRAME

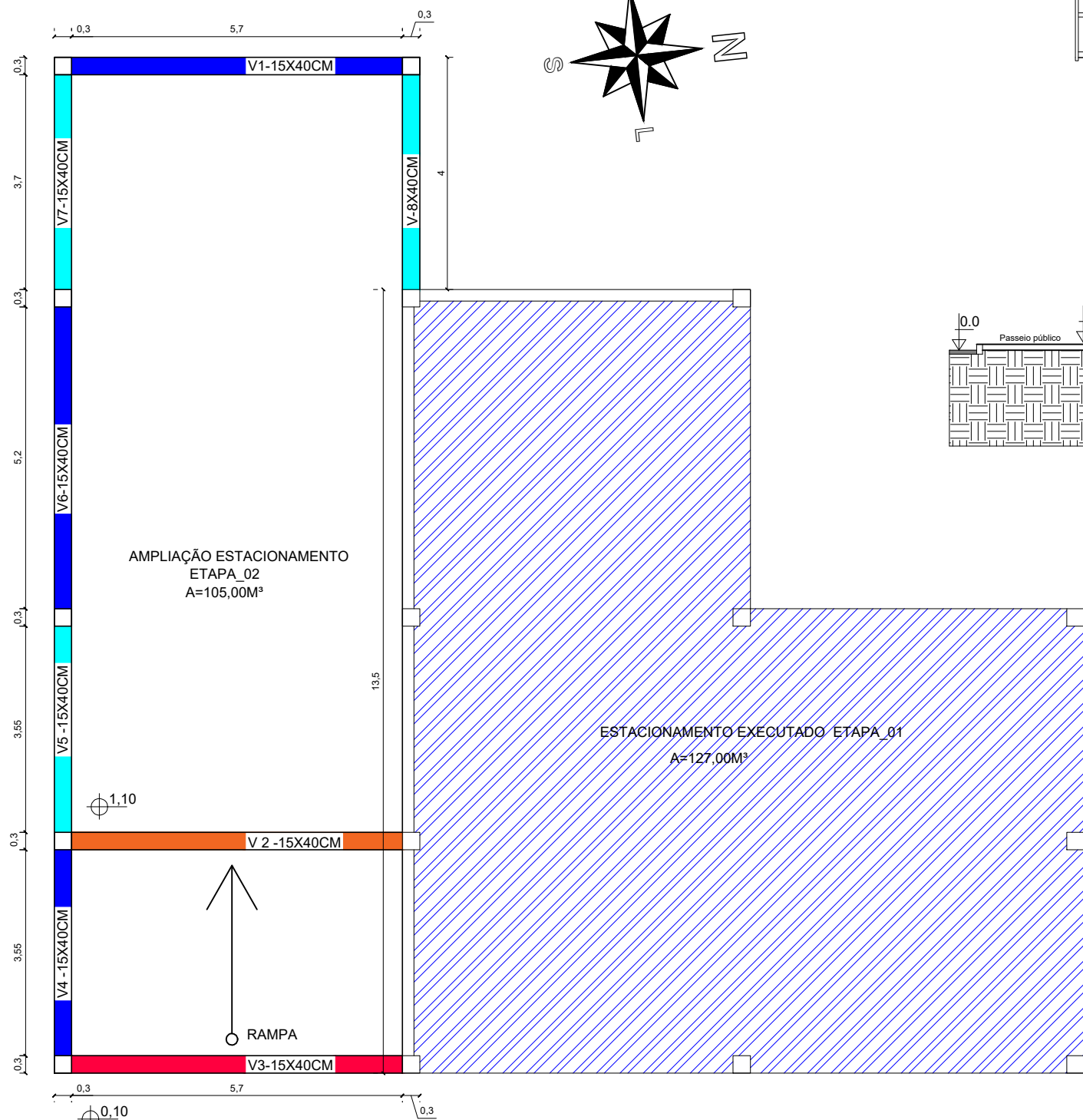

LEGENDA

	V2-15X40CM		V5, V7, e V8-15X40CM
MOLDADA IN LOCO As(+): 2Ø10.0mm As(-): 2Ø8.0mm		PRÉ-MOLDADA As(+): 2Ø12.5mm As(-): 2Ø10.0mm	
	V3-15X40CM		V1 e V6-15X40CM
MOLDADA IN LOCO As(+): 4Ø12.5mm As(-): 2Ø12.5mm		PRÉ-MOLDADA As(+): 3Ø12.5mm As(-): 2Ø10.0mm	
	V4-15X40CM		
MOLDADA IN LOCO As(+): 2Ø12.5mm As(-): 2Ø10.0mm			

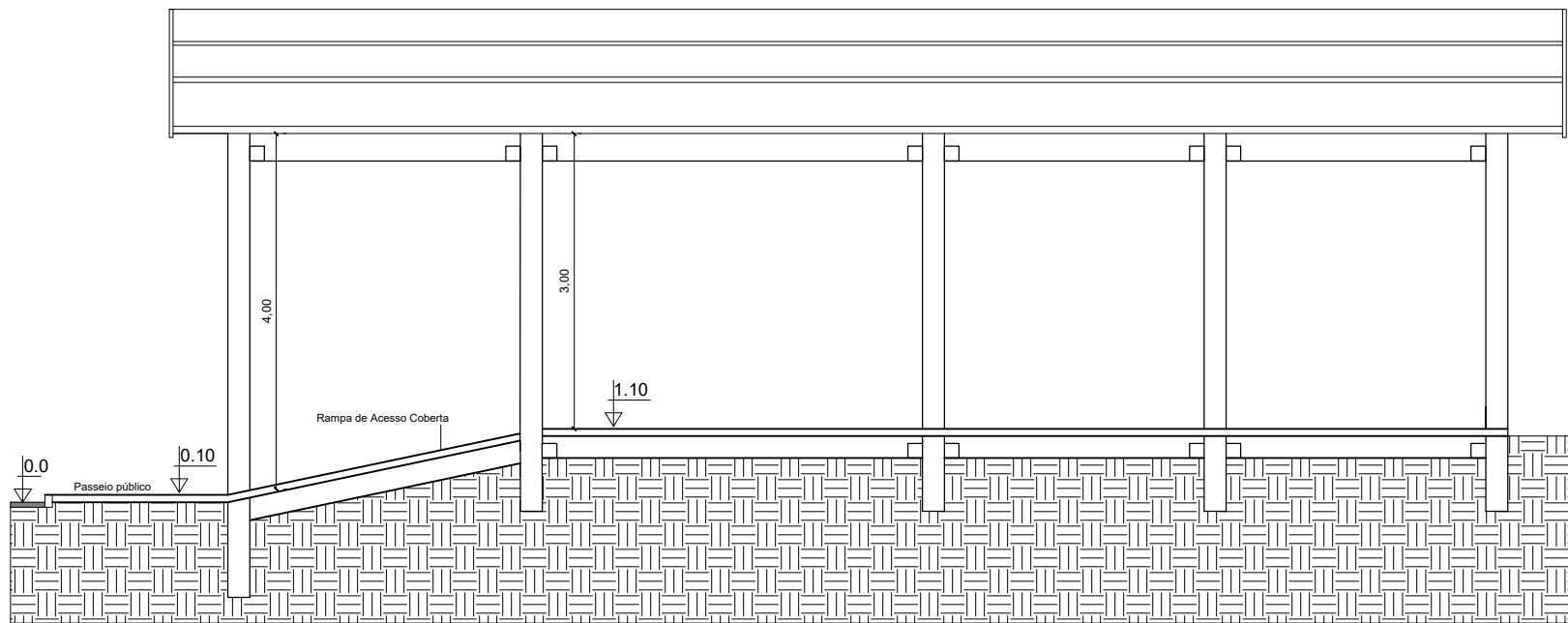

Corte B

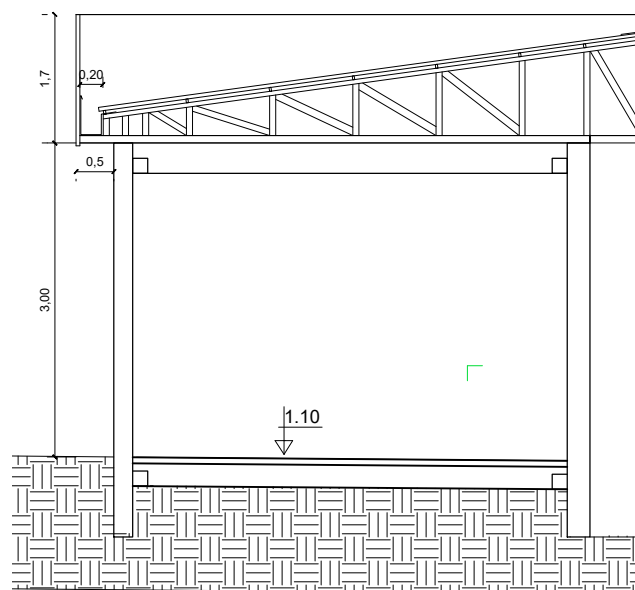

Corte C

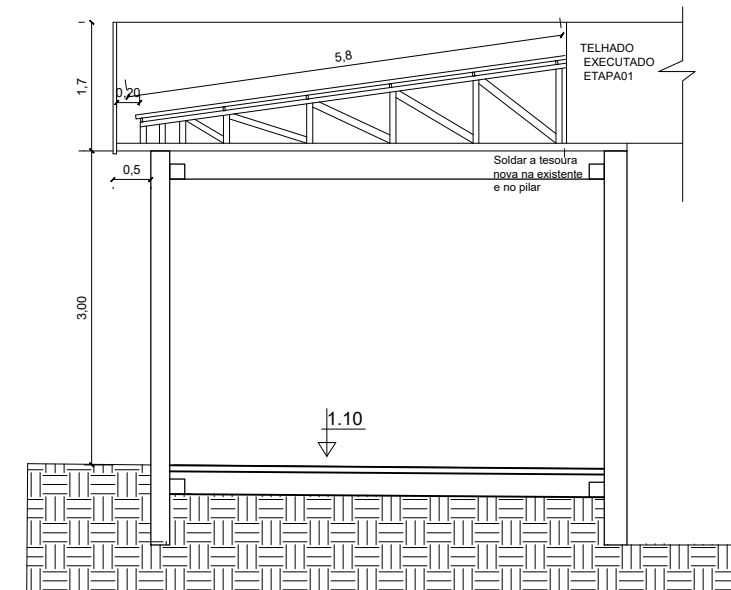

Corte A



PREFEITURA MUNICIPAL DE CAMPOS BORGES

Praça 13 de Abril, 302 - Cep: 99435-000 - Fone/Fax: (54) 3326-1110

OBRA: AMPLIAÇÃO
LOCAL: AV. Mauricio Cardoso, Município de Campos Borges/RS

Descrição:	AMPLIAÇÃO UBS		Data:	AGOSTO/2021	Prancha: 03
Proprietário:	Município de Campos Borges CNPJ 92.406.164/0001-31	RESPONSÁVEL PELO PROJETO:	Marcio Vendruscollo CREA-RS 231.821	Escala:	
				Desenho:	Anelise