

Dimensões Placa = 850x450x13 mm (A-36)
Parafusos = 4Ø16 mm, ISO 898.C4.6
Escala 1 : 10

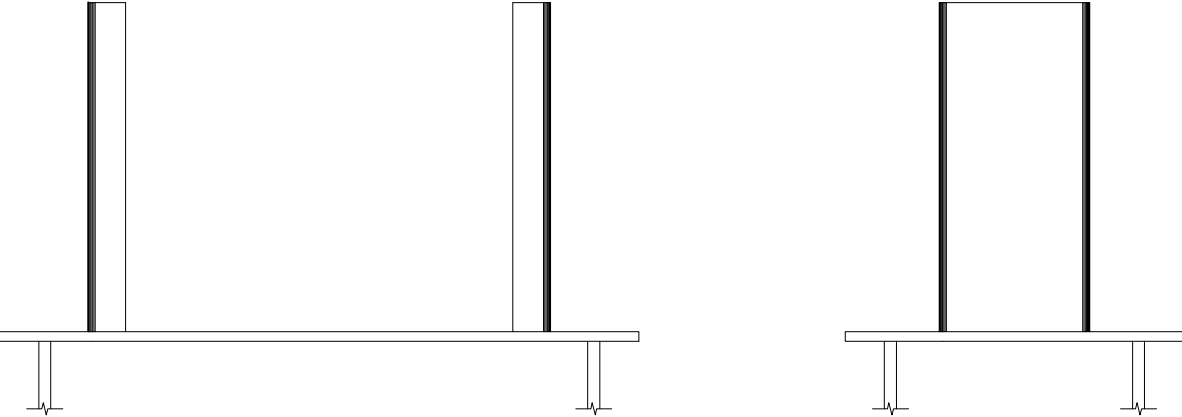

Detalhe Ancoragem Parafuso

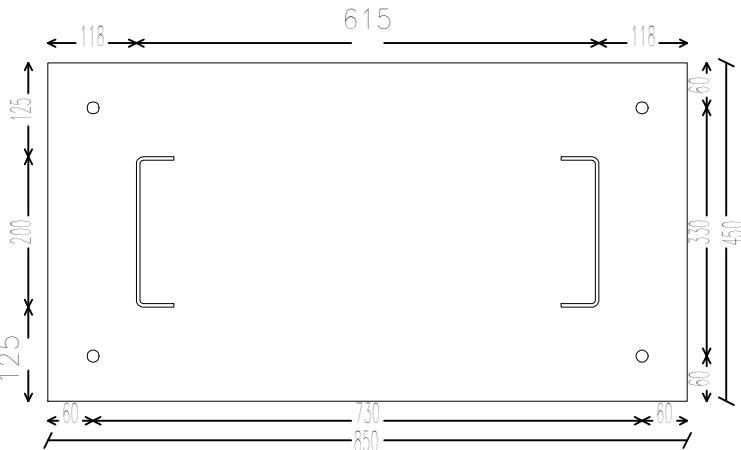

Espessura placa base: 13 mm

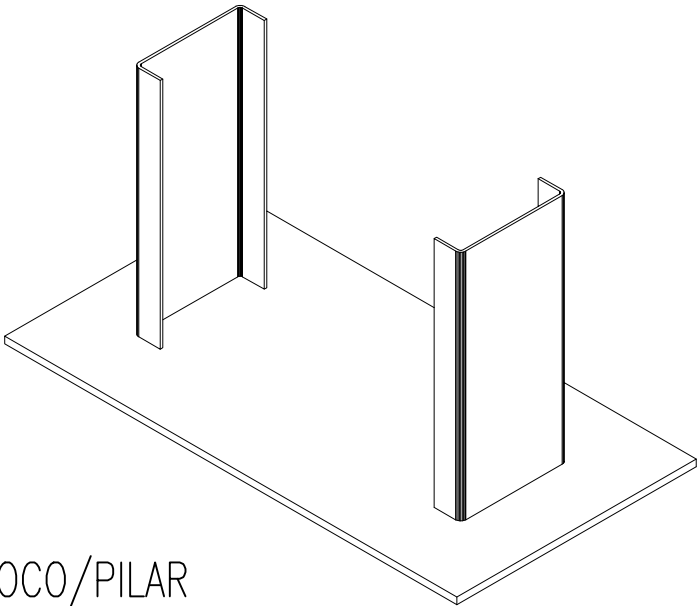
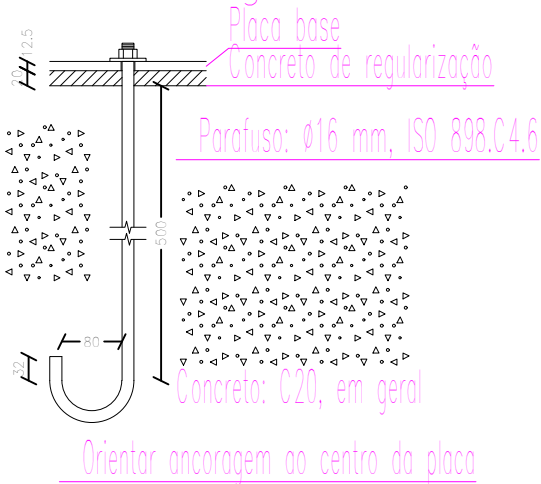

DETLHAMENTO DA LIGAÇÃO BLOCO/PILAR

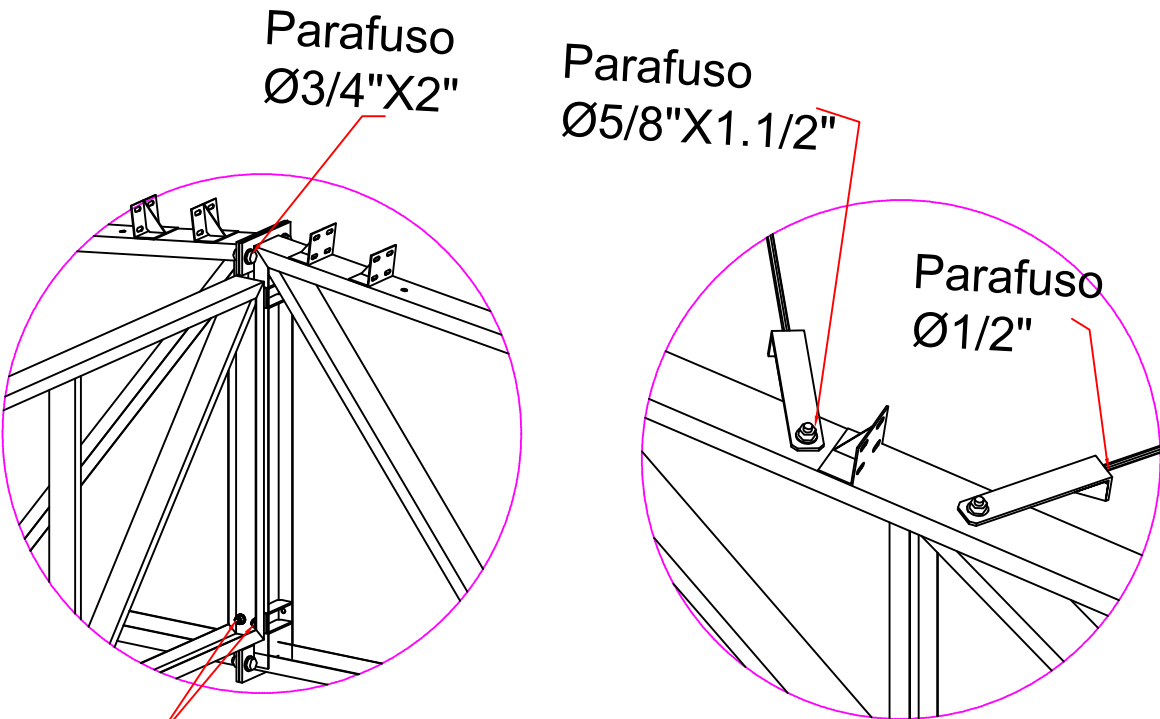

Parafuso
Ø1/2"X1.1/2"

DETLHAMENTO DAS LIGAÇÕES METÁLICAS

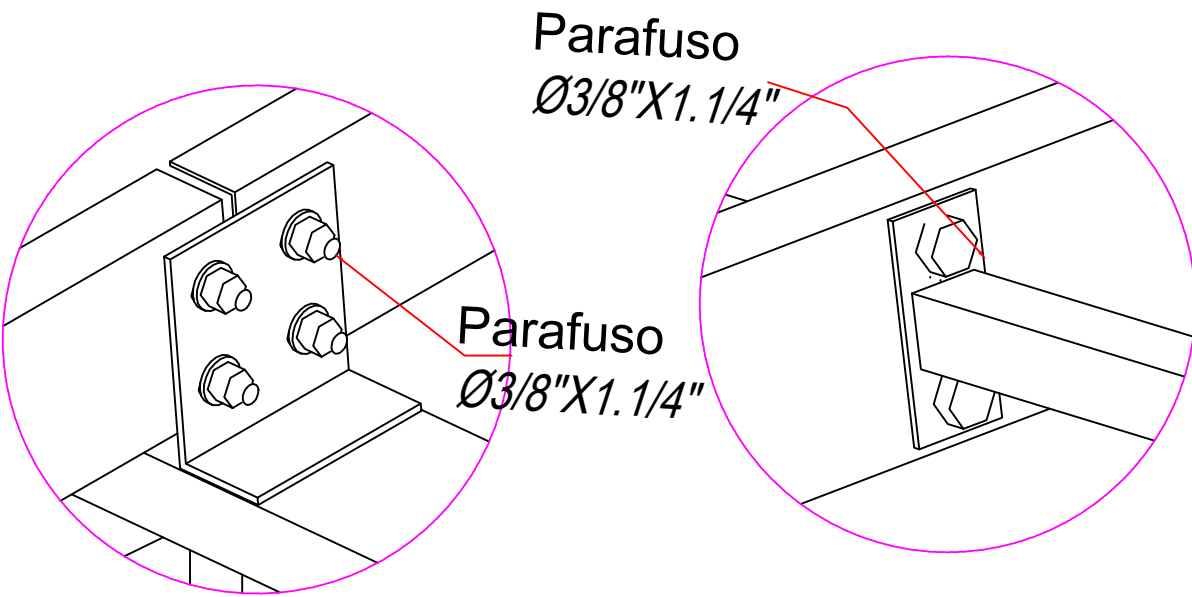

Parafuso
Ø3/8"X1.1/4"

Parafuso
Ø3/8"X1.1/4"

DETLHAMENTO DAS LIGAÇÕES METÁLICAS

QUADRA POLIESPORTIVA - ESCOLA EDUCARTE					
PROPRIETÁRIO:			RESPONSÁVEL TÉCNICO:		
 PREFEITURA MUNICIPAL DE ERNESTINA			CIBELE SERAFINI ENGENHEIRA CIVIL - CREA 183.912		
MAYLLU BERVIAN BISPO ENGENHEIRA CIVIL - CREA 281.048					
ÁREA TOTAL:	ESCALA:	PROJETO:	DATA:	PRANCHA:	
382,50m²	Sem Escala	DETLHAMENTOS	ABR/2020	08/08	