





QUADRA EXISTENTE

-  PAREDE BLOCO MACIÇO E= 20 CM
-  PAREDE BLOCO VAZADO E= 15 CM
-  PILAR A CONSTRUIR
-  PILAR EXISTENTE

**PLANTA BAIXA**  
A: 139,60 m<sup>2</sup>

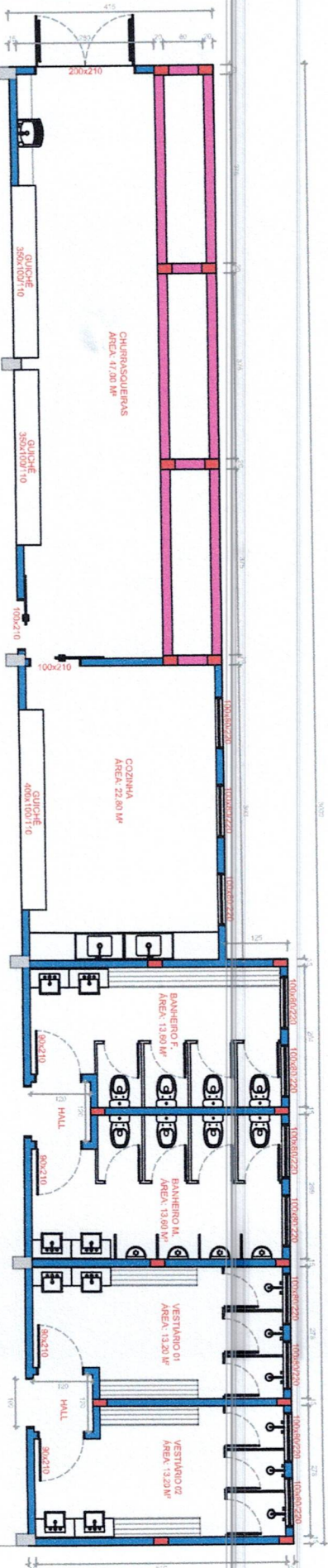

**PROJETO ARQUITETÔNICO**

Campo Municipal, Sagrada Família/RS.

Página: 1

Proprietário:

Assunto: Planta Baixa

Resp. Técnico:  
Douglas Borba  
Eng. Civil  
CREA/RS 254591

**Douglas Borba**  
Engenheiro Civil  
CREA/RS 254591  
CPF 041.424.520-29

Data: Mar/2024

Escala: 1:150

CREA/RS 254591

CPF 041.424.520-29

