

— ENG **PLANTA BAIXA GOLEIRA**
ESCALA - 1/25

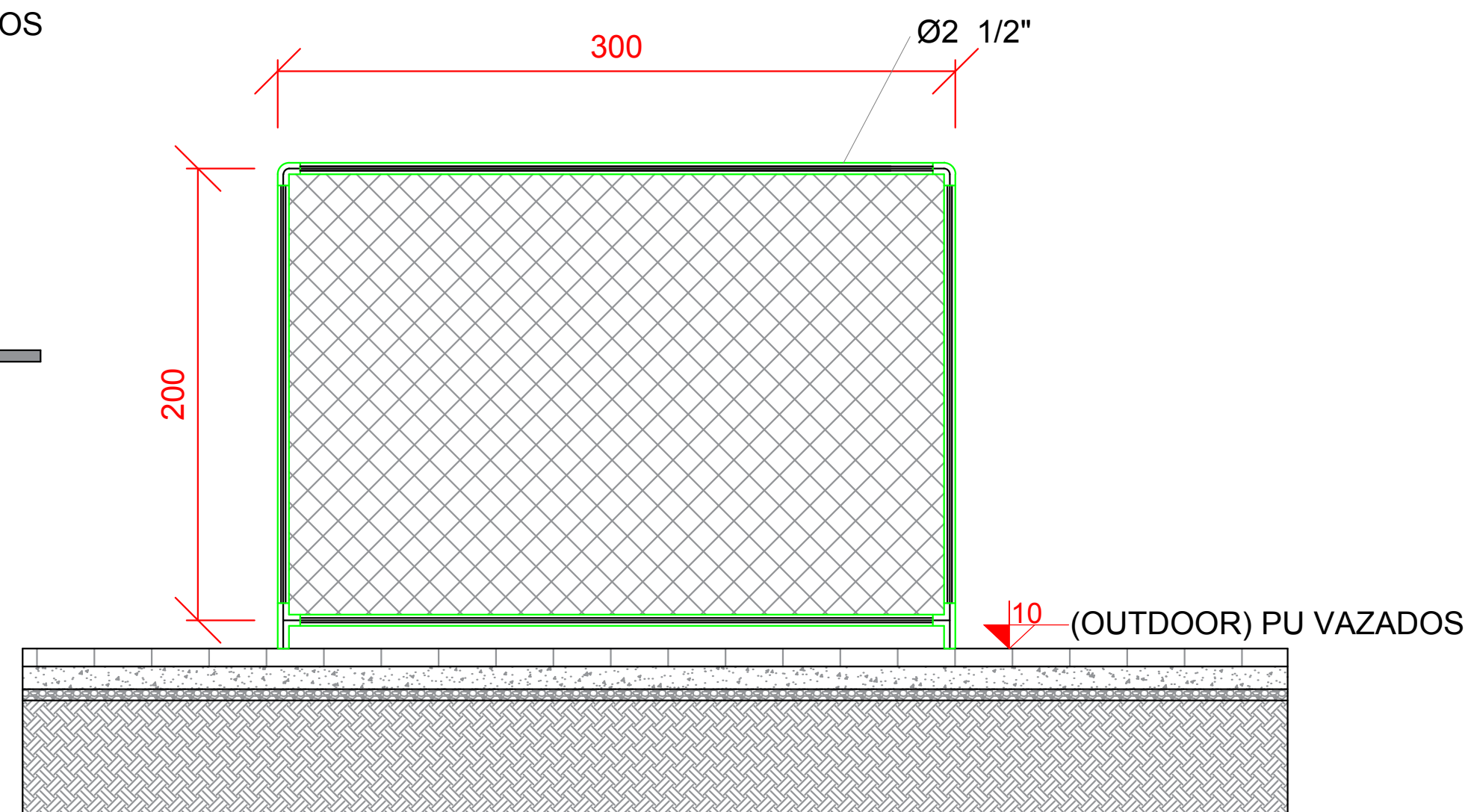

ENG ELEVAÇÃO 1 - GOLEIRA
ESCALA - 1/25

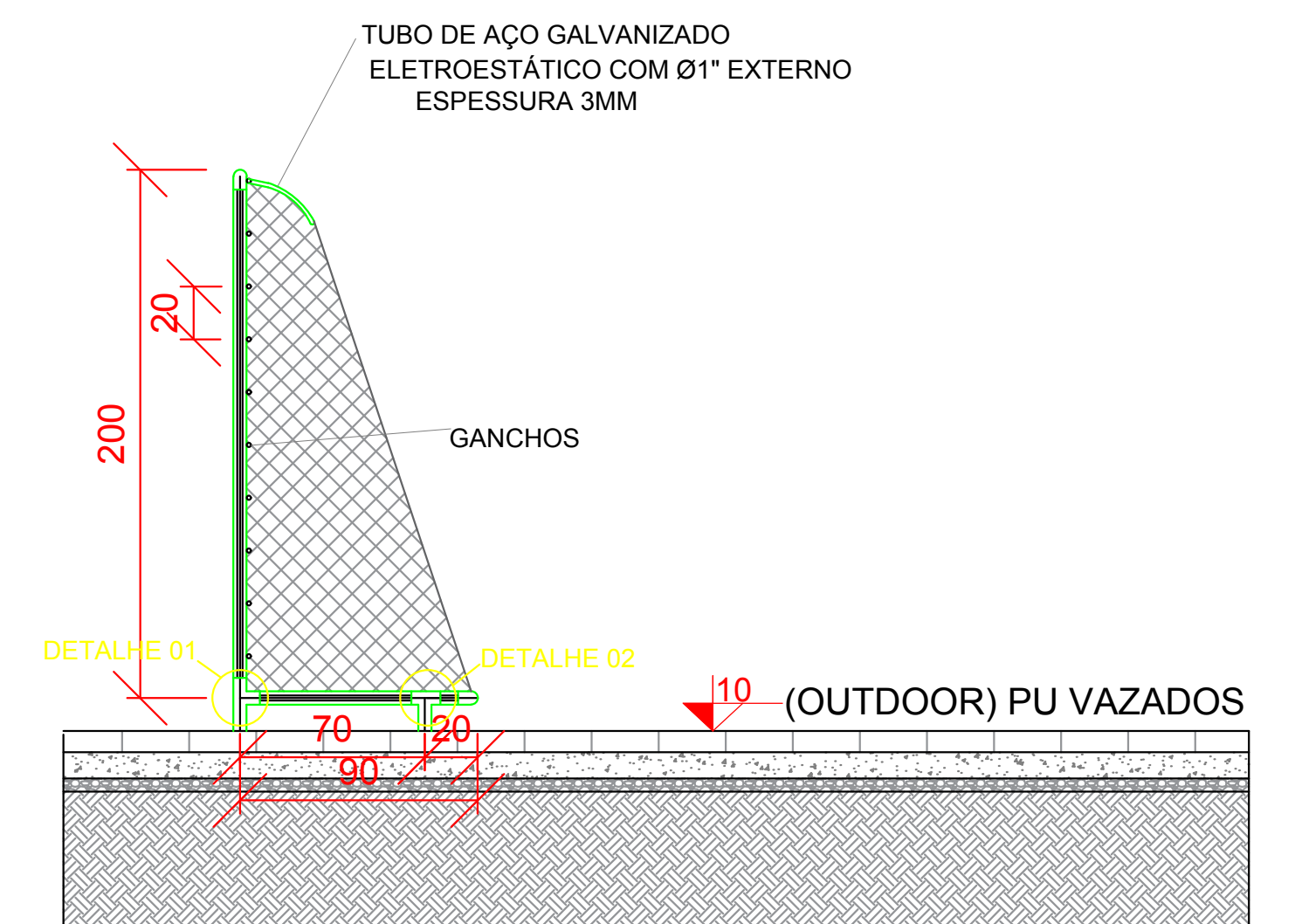

— ENG **ELEVAÇÃO 2 - GOLEIRA**
ESCALA - 1/25

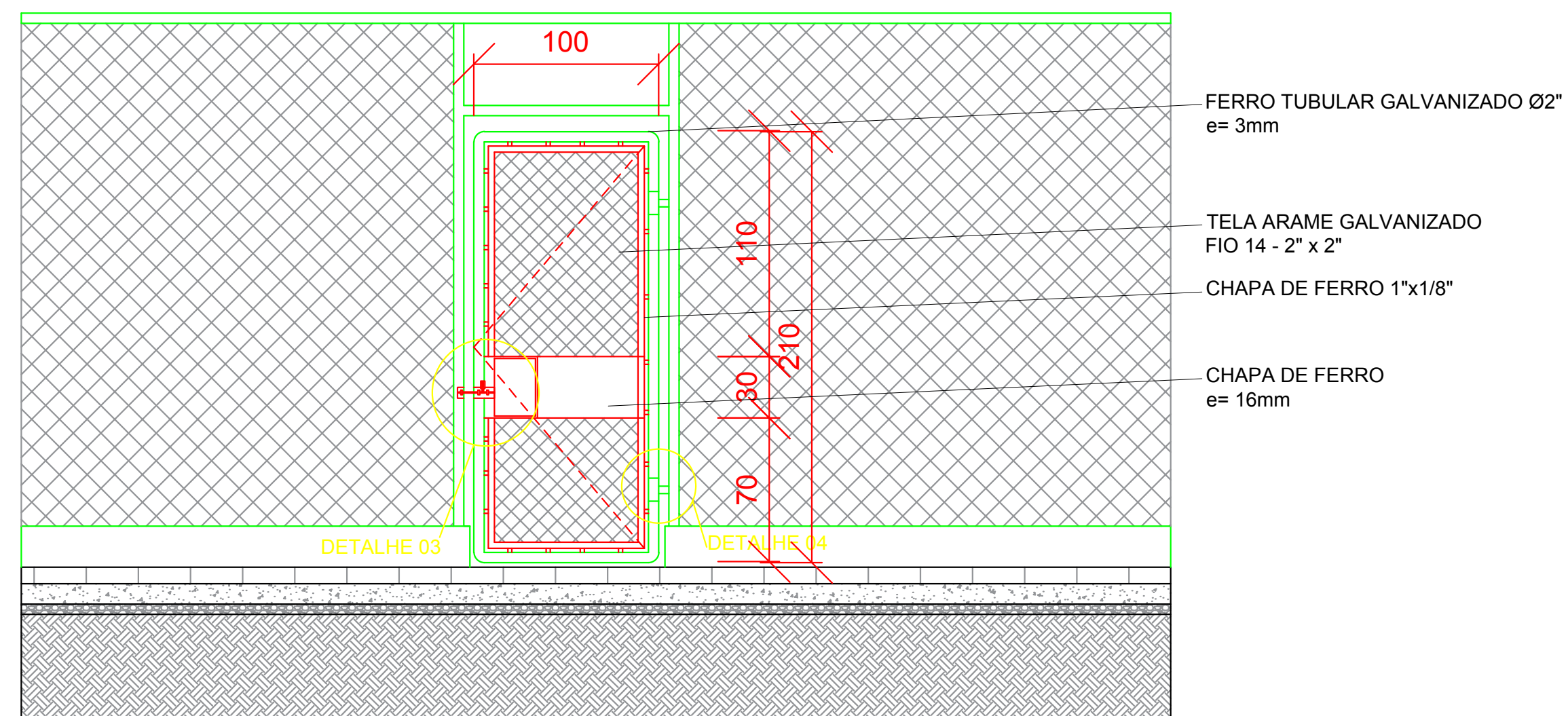
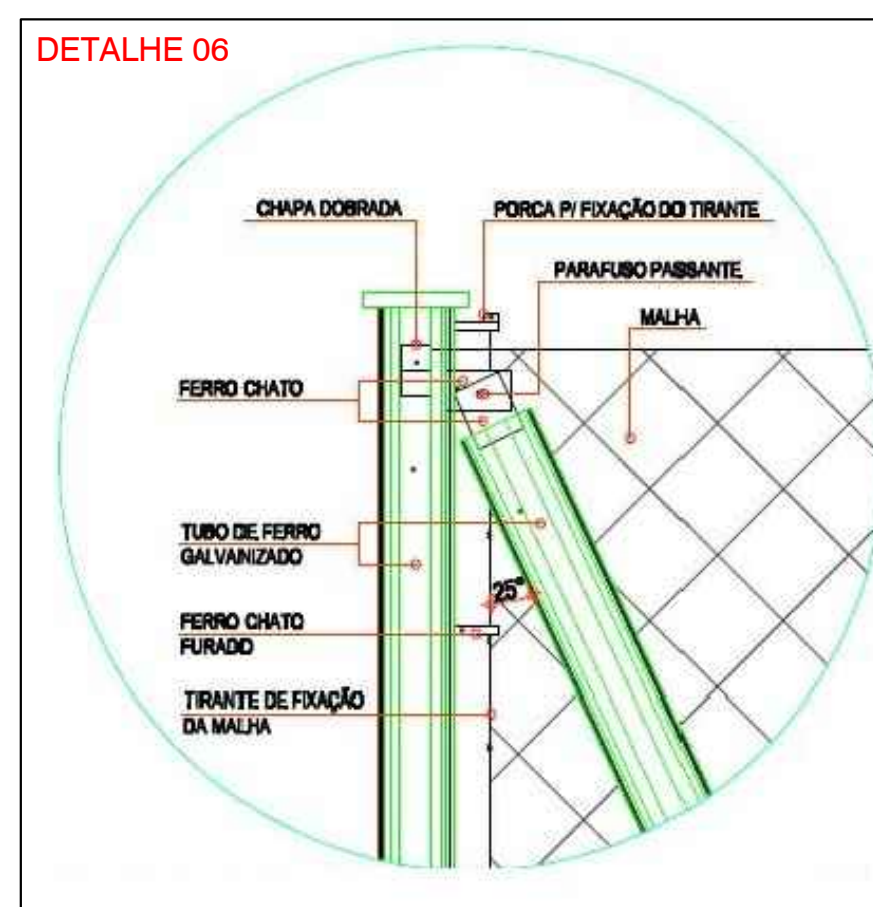
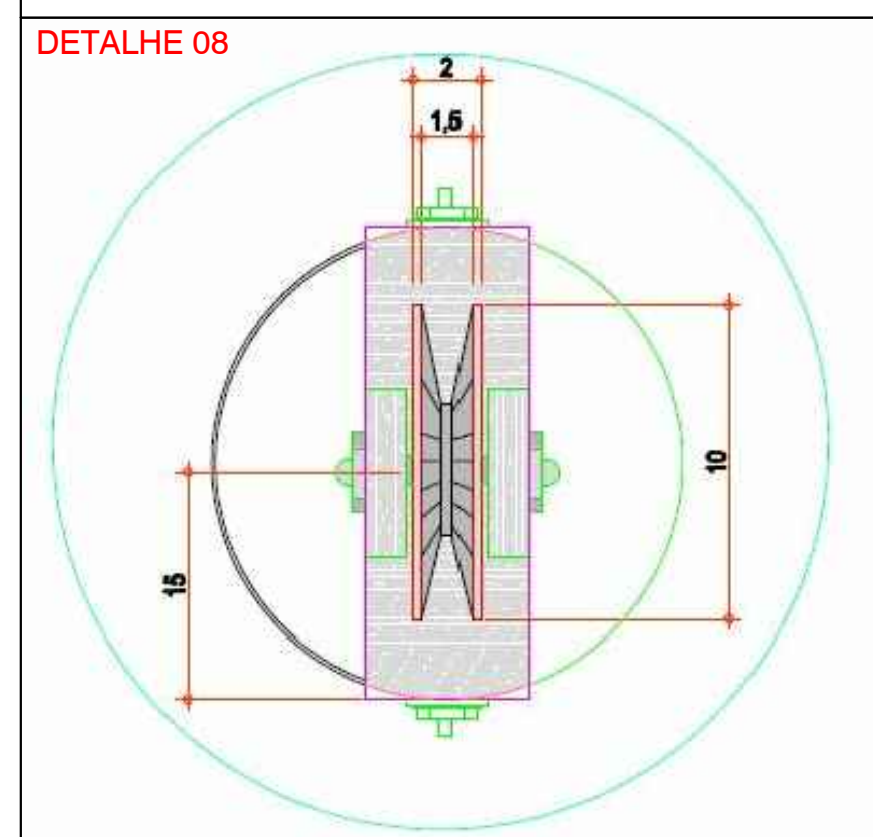
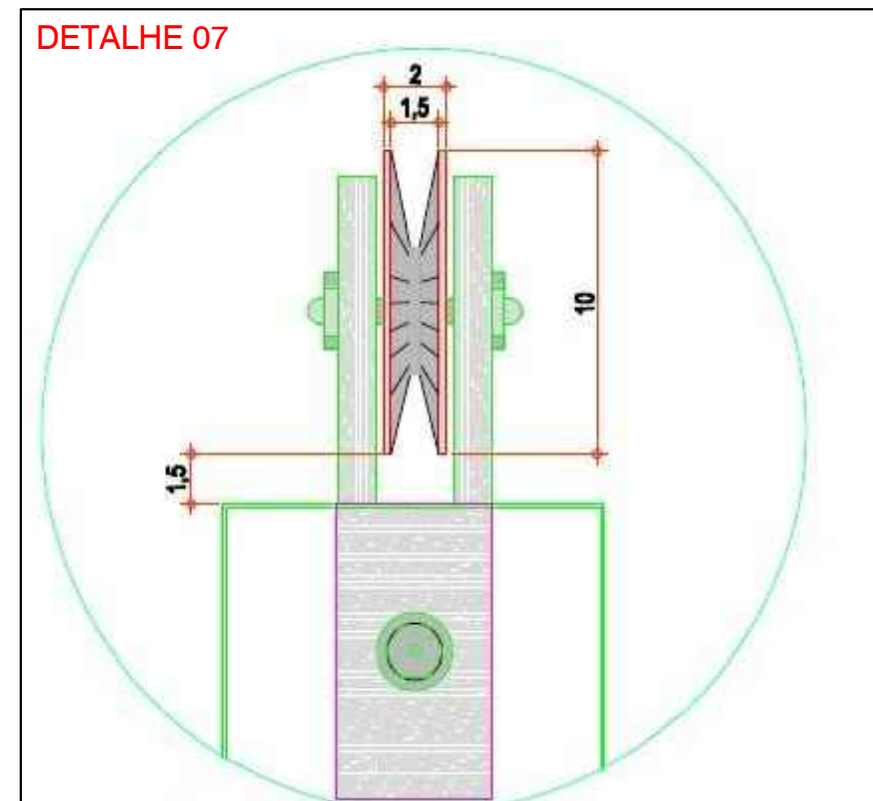
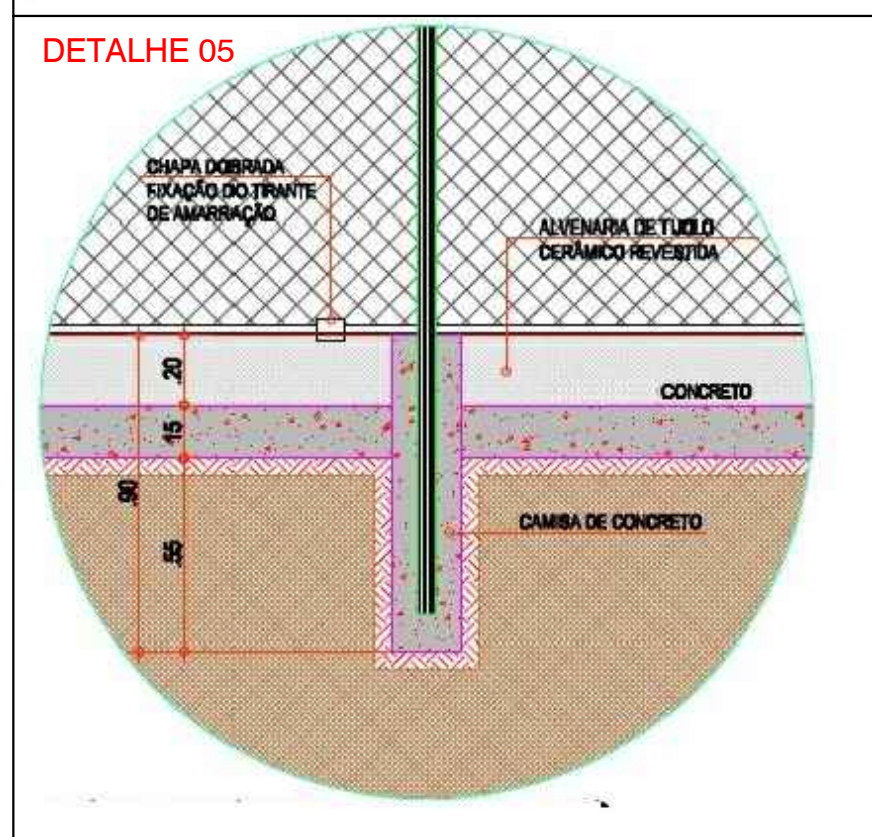
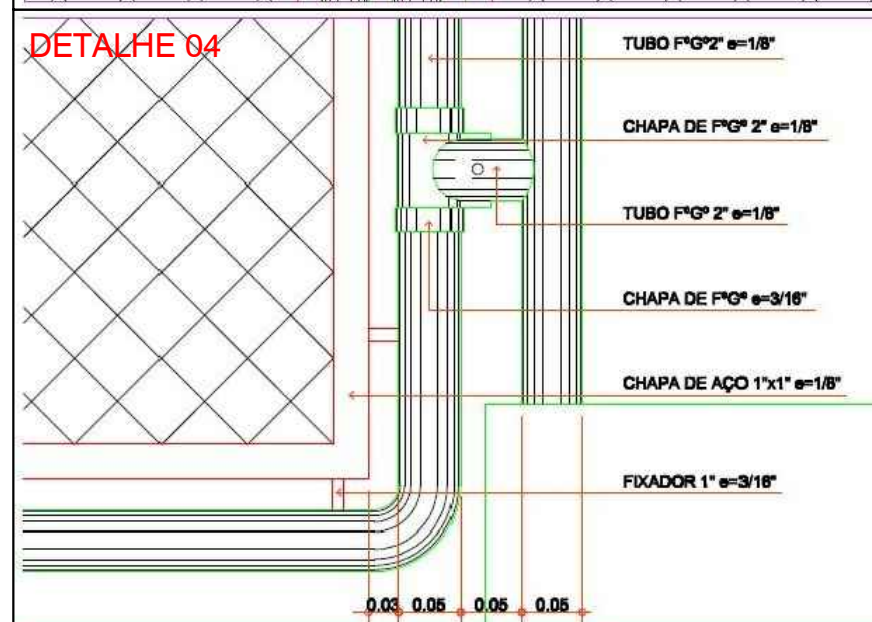
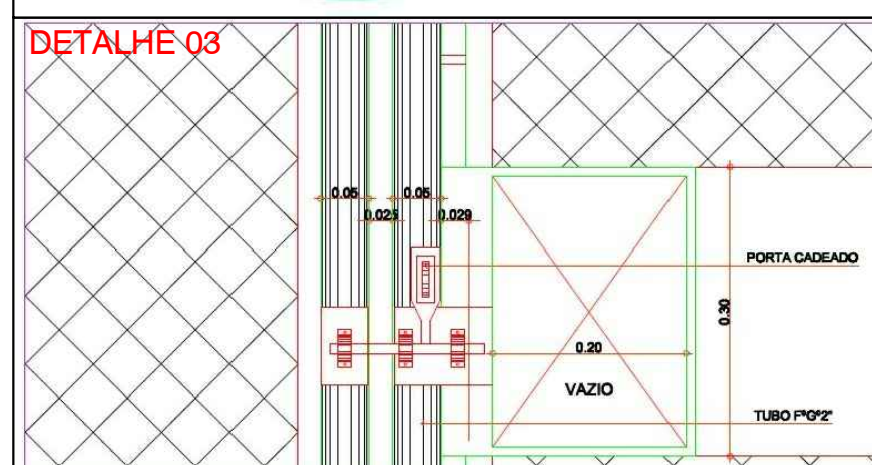
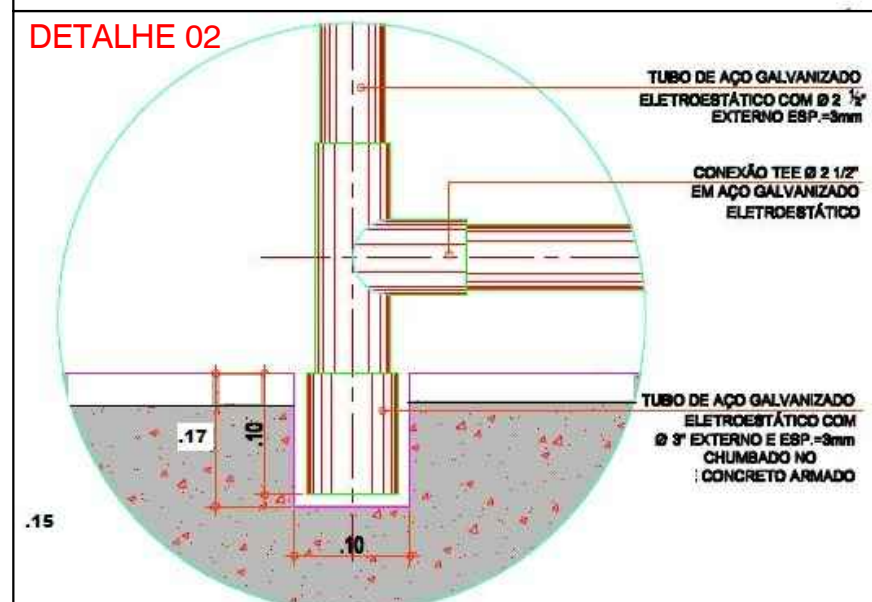
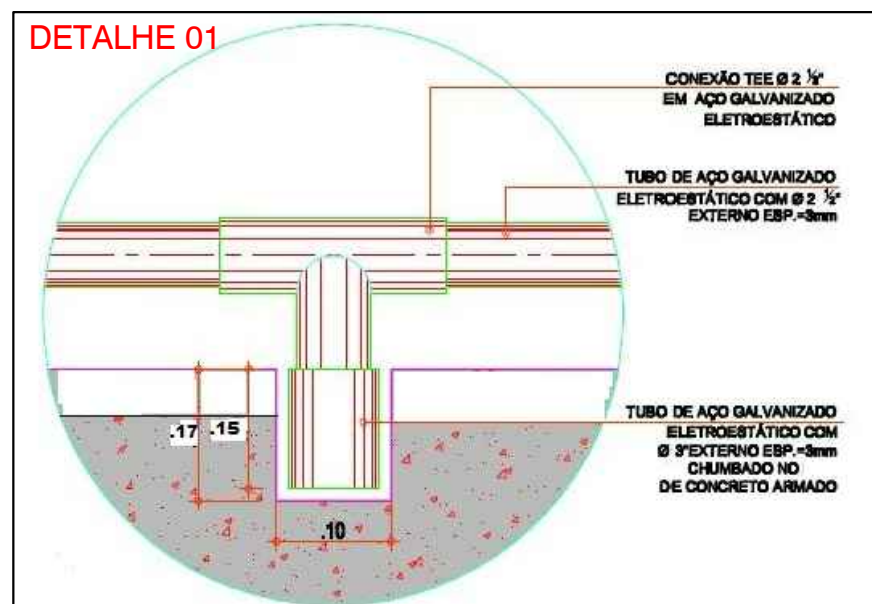

— ENG **ELEVAÇÃO 2 - PORTÕES DAS QUADRAS**
ESCALA - 1/25

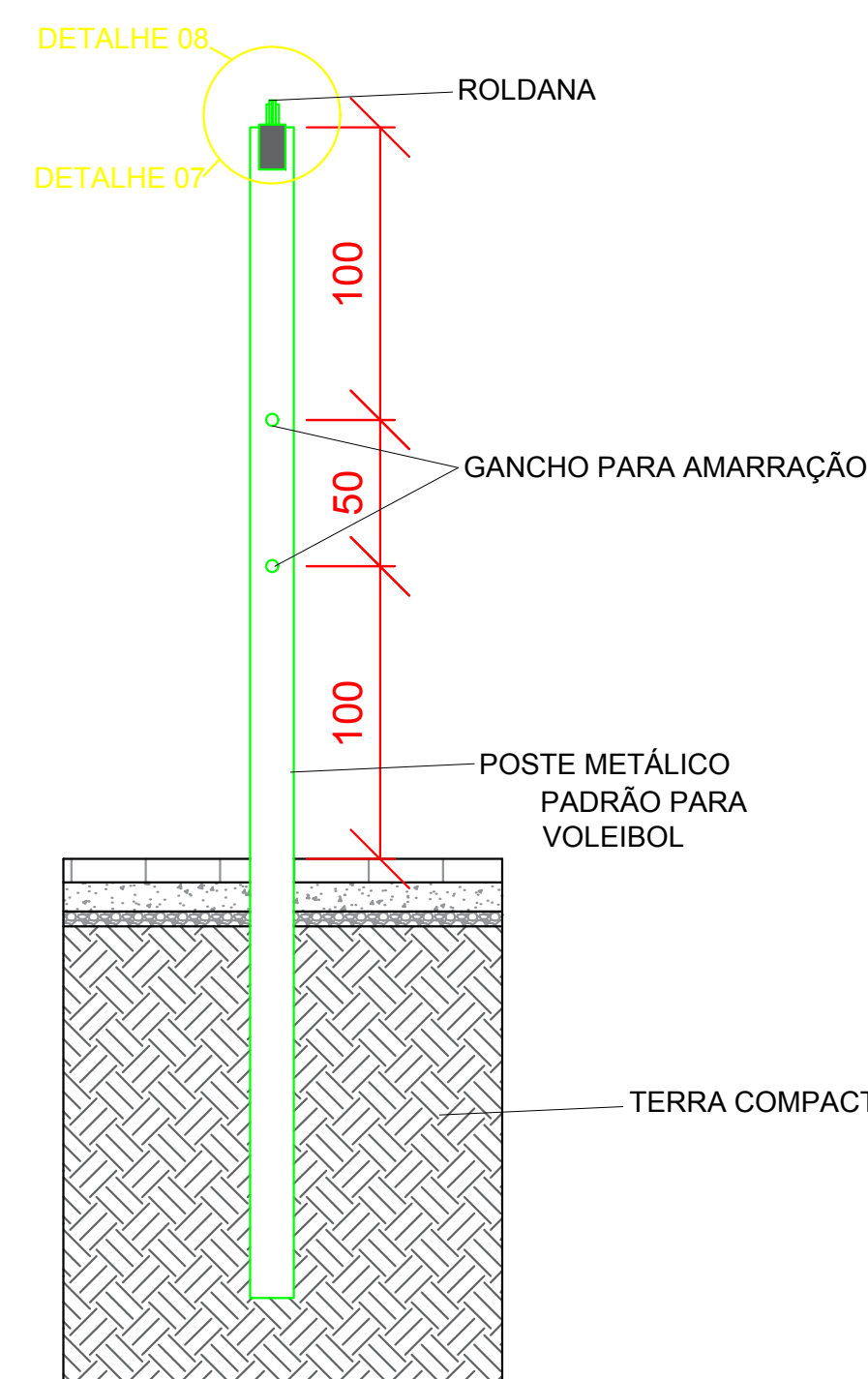

— ENG VISTA FRONTAL
ESCALA - 1/25

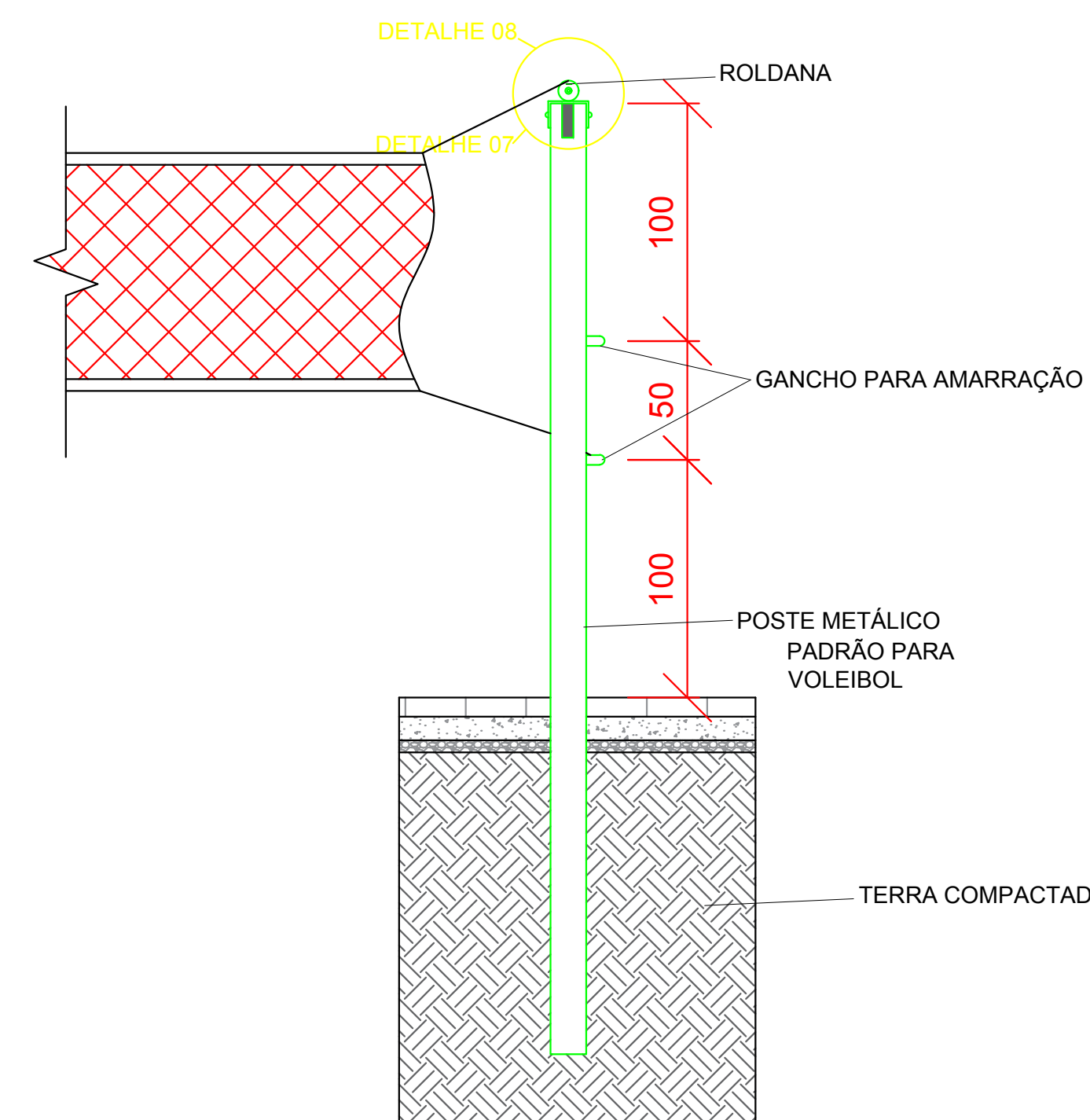

— ENG VISTA LATERAL
ESCALA - 1/25

HERGYA APARECIDA KELLER ENGENHEIRA CIVIL CREA-RS 219763		PROPRIETARIO(A): PREFEITURA MUNICIPAL DE SALDANHA MARINHO CNPJ: 92.399.153/0001-71	
TIPO	PROJETO DE REVITALIZAÇÃO E FECHAMENTO DE QUADRAS VOLEI/FUTSAL		
DESIGNAÇÃO	DETALHES DOS EQUIPAMENTOS DAS QUADRAS		
ENDEREÇO	AV. SILVA TAVARES ESQ. JACOB LIMBERGER (S=01, Q=18, L=395)		
LOCAL	SALDANHA MARINHO - RS		FRANCHA Nº
DATA	HERGYA APARECIDA KELLER	PREF. MUN. DE SALDANHA MARINHO	04
27/04/2020			ESCALA 1:25